

RTN/M2(L)B...

Weighing module for
RTN load cells 1 t ... 33 t

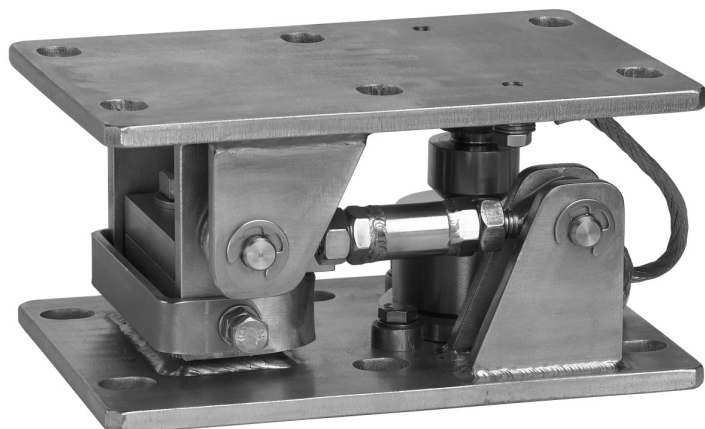

Special features

- Compact design
- Designed with pendulum bearings
- Integrated anti-lift device
- Integrated horizontal stops
- Load cell dummy in scope of delivery
- Rust-resistant materials up to nominal load 22 t
- With stay rod
(→ also available without stay rod)
- TÜV certified

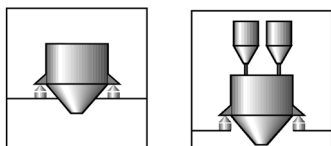

Dimensions (in mm; 1 mm = 0.03937 inches)

Maximum capacity 1 t ... 4.7 t

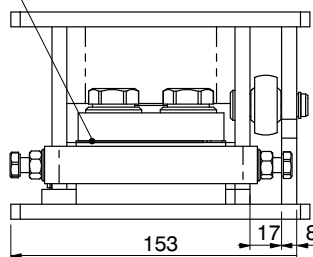
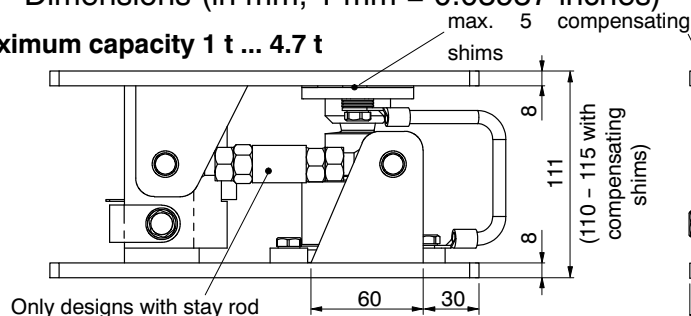

Perspective view:

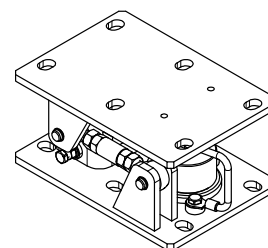

View from above:

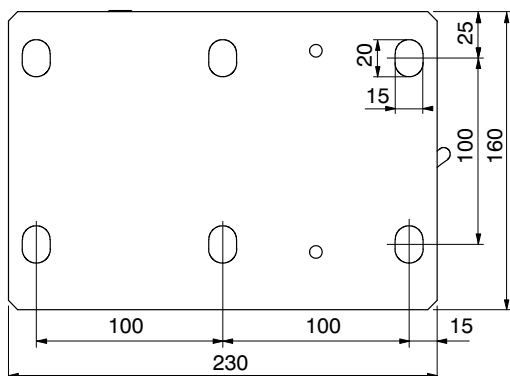

View from below:

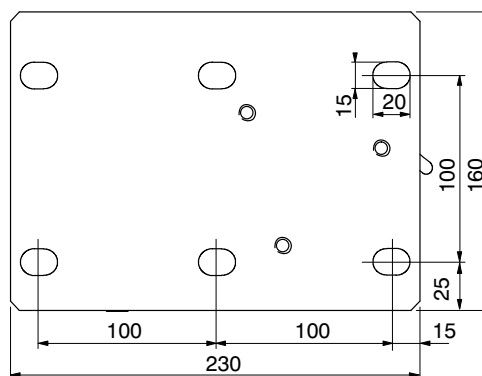

Dimensions (in mm)

Maximum capacity 10 t ... 22 t

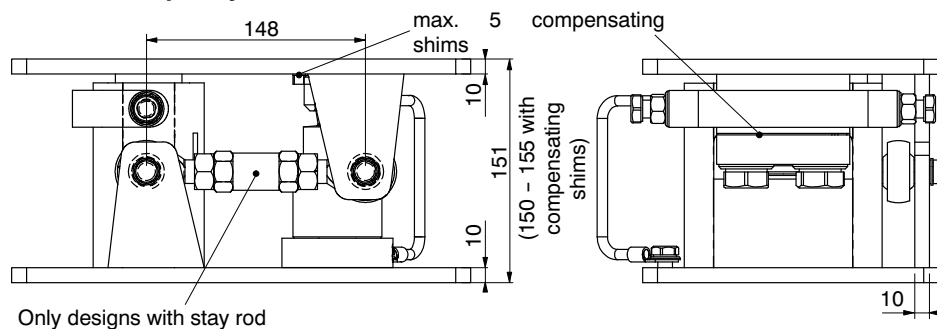

View from above:

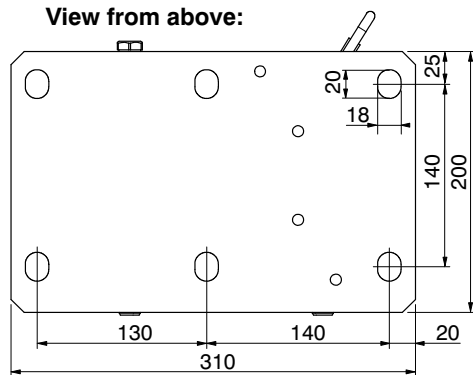

View from below:

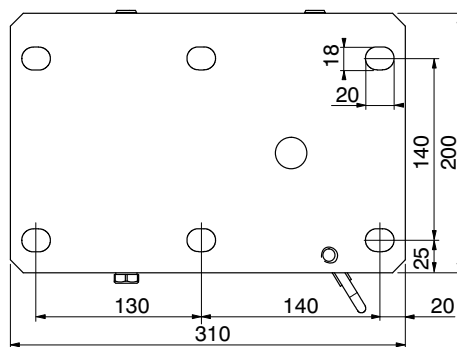

Maximum capacity 33 t

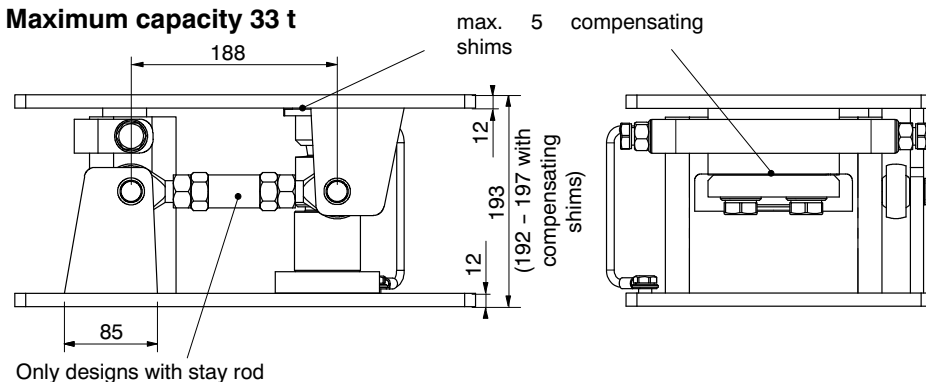

View from above:

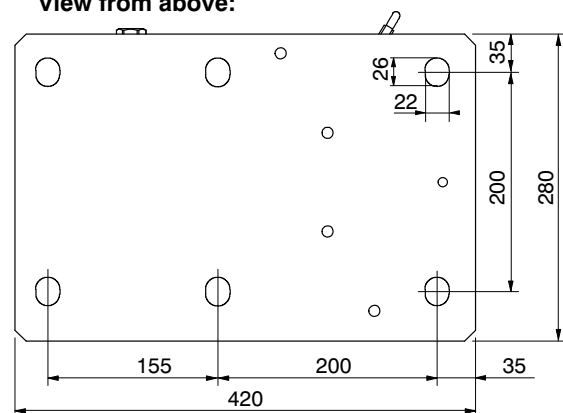

View from below:

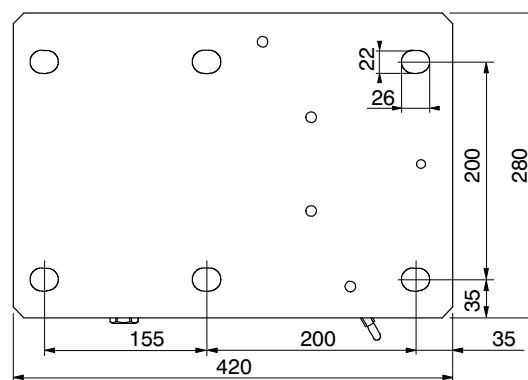

Specifications

Type		RTN/M2LBR4.7T			RTN/M2LBR22T			RTN/M2LB33T
Maximum capacity (E _{max}) of load cell	t	1	2.2	4.7	10	15	22	33
Limit load	% of E _{max}	150						
Max. permissible loading of horizontal stops transverse to stay rod axis		10						
Restoring force per 1 mm deflection [% of applied load]		16.5		16.5	13		8.2	
Max. permissible horizontal deflection	mm	1.5		1.3	2		3.5	
Max. permissible lifting force ¹⁾	kN	20			50		50	
Max. permissible horizontal force in stay rod axis ¹⁾	kN	10			30		50	
Material: Metal components		Stainless steel ²⁾						Zinc galvanized
Weight (with dummy), approx.	kg	9.5			20		41	
Minimum lifting height to install load cell	mm	10						
Height adjustment with supplied shims	mm	5						

¹⁾ Specifications based on DIN 18800

²⁾ As per EN 10088-1

Product variants:

Order number	Maximum capacity	Material	Design
1-RTN/M2LBR4.7T/2	1 t ... 4.7 t	Stainless steel	WITH stay rod
1-RTN/M2BR4.7T/2			WITHOUT stay rod
1-RTN/M2LBR22T	10 t ... 22 t	Stainless steel	WITH stay rod
1-RTN/M2BR22T			WITHOUT stay rod
1-RTN/M2LB33T	33 t	Zinc galvanized	WITH stay rod
1-RTN/M2B33T			WITHOUT stay rod

Scope of supply:

Complete mounted weighing module with lateral stay bar (without RTN load cell).

Attention: A dummy is installed in place of the load cell. This is set up according to the specifications listed above. Please note that the container must be raised in mounted condition by min. 10 mm in order to replace the dummy with a load cell.

RTN load cell options:

- **Ex-protection design as per ATEX:**
 - II 2 G EEx ia IIC T4 or T6 (Zone 1) *)
 - II 3 G EEx nA II T6 (Zone 2)
 - II 2 D IP68 T 80°C (Zone 21) *)
 - II 3 D IP68 T 80°C (Zone 22 for non-conductive dust)
 - *) with EC-type examination certificate
- **Operating temperature range increased to 110 °C** (not possible in connection with ATEX)

Additional information about the relevant load cells can be found in our RTN load cells data sheet.

Installation examples of weighing modules with stay rods

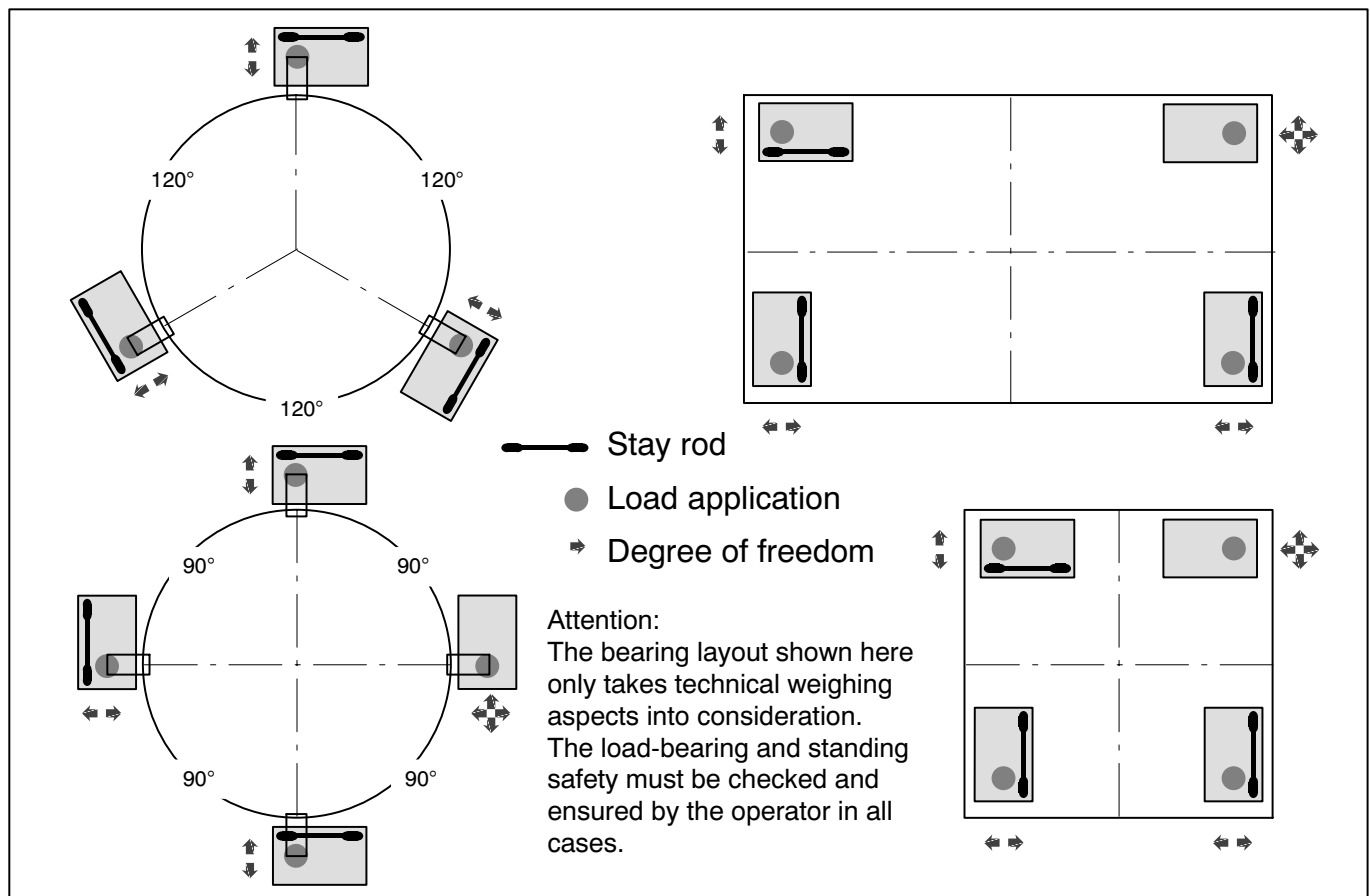

Further accessories:

RTN fixed bearing with same installation height as the module. Further information can be found in a separate data sheet.



Modifications reserved.

All product descriptions are for general information only. They are not to be understood as a guarantee of quality or durability and do not constitute any liability whatsoever.

Hottinger Baldwin Messtechnik GmbH

Im Tiefen See 45 · 64293 Darmstadt · Germany
Tel. +49 6151 803-0 · Fax: +49 6151 803-9100
Email: info@hbm.com · www.hbm.com

measure and predict with confidence

